

## OPERATING INSTRUCTIONS

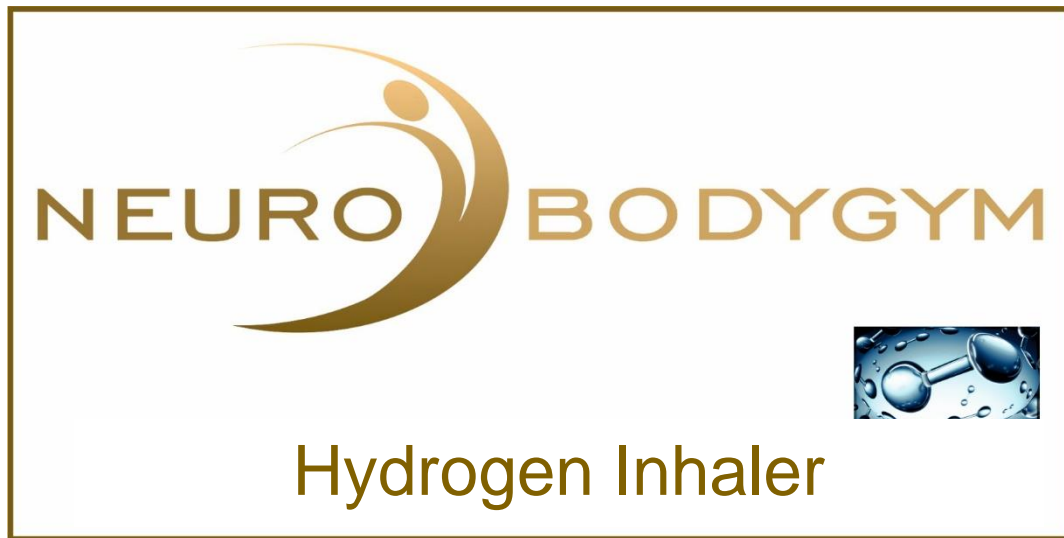

## SetUp/Installation

### Step 1: Preparation of the filter container

Fasten the retaining clip to the device using the screw

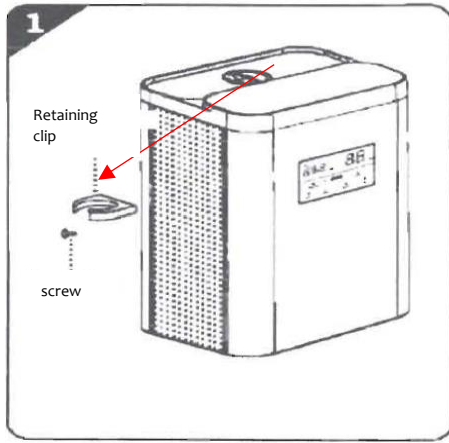

Correctly fastened retaining clip

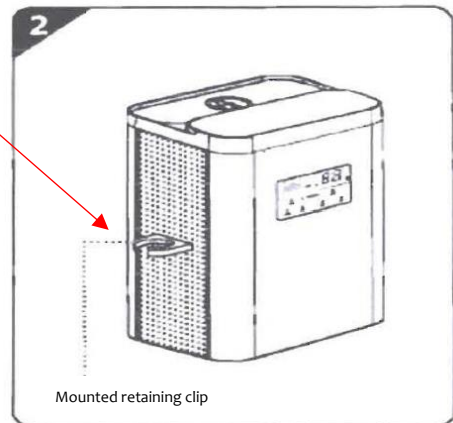

Fill in 1000 - max. 1300ml distilled water

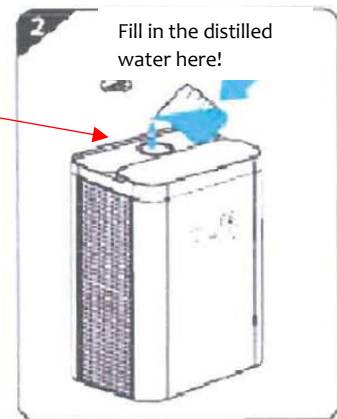
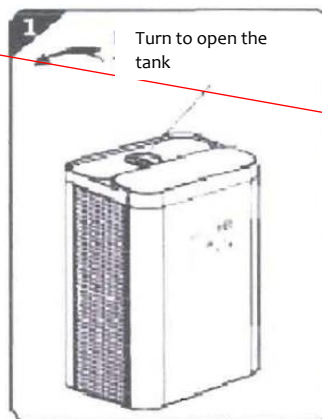

#### Before first use:

To open the tank, turn the cross and remove the orange ring!

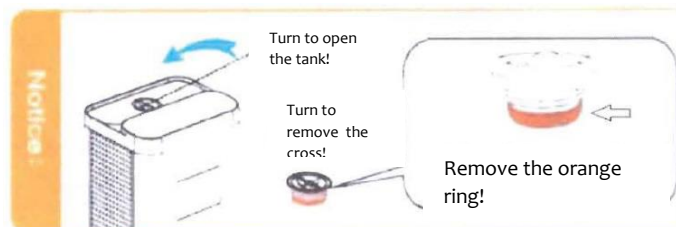

An acoustic signal indicates when the container is sufficiently full.

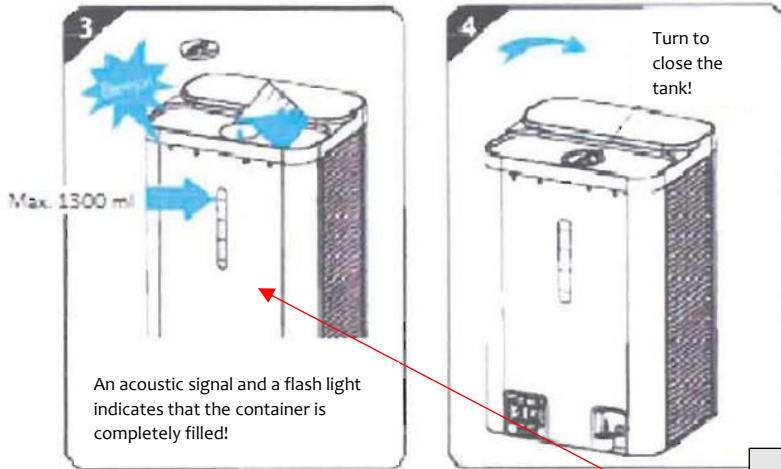

**1000 - max. 1300 ml distilled water!**  
**Please pay attention to the signal and the fill indicator!**

**step 2: Preparation of the cannula-connection**

Connect now the filter tank with the H2-cannula-connection!

Fill the little container with water. The container opens counterclockwise!

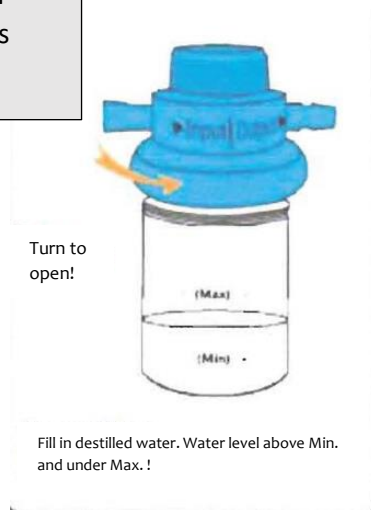

H2 Output at the unit

Connect the nose cannula here!

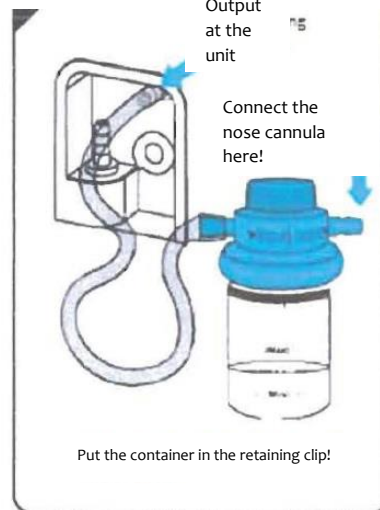

Put now the little container in the retaining clip!

Connect the hose which comes out at the H2 outlet of the unit with the little container!

**step 3:**

Connect the power cable and put the main toggle switch to ON (I)!

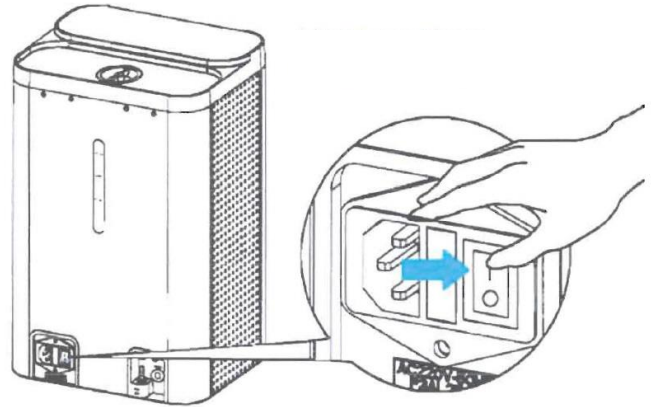

Connect now the nose cannula with the filter container and put on the nose cannula correctly. Now the device is ready for use.

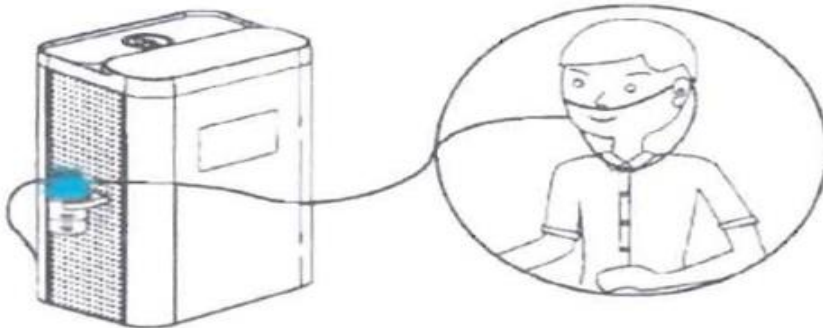

**step 4: personalised use**

**A. Press Time button  
REPEATEDLY, until you  
have set your desired  
application time!**

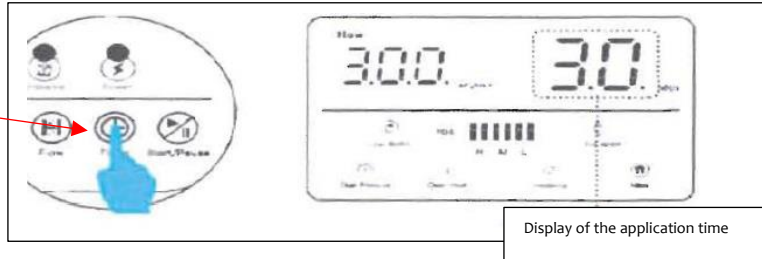

Select your individual application time, f.e. 30 minutes, 60 minutes or 2 hours etc.

**B. Press the button  
FLOW -  
This is how to switch  
between the H2  
quantity!  
(300 or 600 ml)**

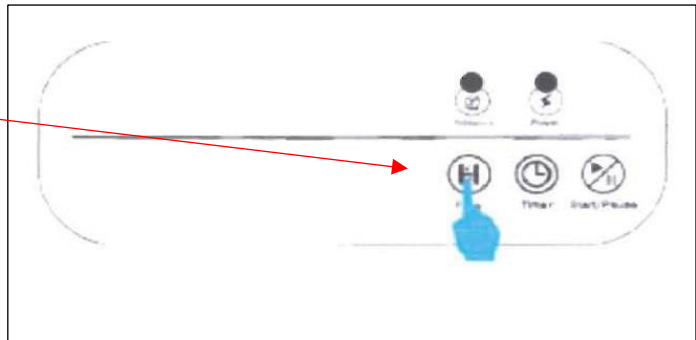

**C. Press the button  
START/PAUSE to start  
the application!  
Press the button  
START/PAUSE to end the  
application!**

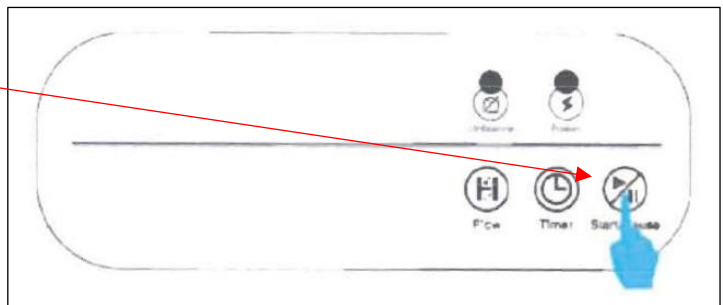

NeuroBodyTech GmbH, Waldstrasse 22, 83132 Pittenhart, managing director: Martin Rusam, Local Court München - HRB 241499  
Tax Number.: 163/133/30102 (Finanzamt Traunstein), VAT-Nr.: DE320815970 EORI-Nr.: DE385010756645310 (Hauptzollamt Rosenheim)

Showroom & Data analysis: Seestrasse 39 (1. Stock), 83209 Prien am Chiemsee  
Technology & Software development: Bernauer Strasse 21 (1. Stock), 83209 Prien am Chiemsee  
Head office: Waldstrasse 22, 83132 Pittenhart im Chiemgau